



**The Japan Society for Environmental Education**

**The 34<sup>th</sup> Annual Meeting: Tottori Announcement**

**Conference Theme:**

**“Weaving ourselves with gifts from nature and everyday lives”**

## Meeting Contents and Program

August 25 (Friday) ~ 28 (Monday), 2023

Host: The Japanese Society for Environmental Education  
(Conference Organizing Committee for the 34<sup>th</sup> Annual Meeting)

Venue: Tottori University, Tottori Campus  
Tottori Sand Dune Visitor Center, Kurashiki City Environment Study Center

## Table of Contents

<b>1. Greetings from the Chairman of the Executive Committee</b> .....	1
<b>2. Outline of the Event</b> .....	1
<b>3. Conference Schedule</b> .....	2
<b>4. About the Venue</b> .....	4
<b>5. Information for Participants</b> .....	9
<b>6. About Oral Presentations</b> .....	10
<b>7. About Poster Presentations</b> .....	13
<b>8. About Independent Research Presentations</b> .....	13
<b>9. Society Events for Participants</b> .....	14
<b>10. Public Events</b> .....	16
<b>11. Presentation Programs</b> .....	18

### [List of Conference Organizing Committee]

Chairman	Tadashi OOTANI (Tottori University)
Co-Chairman	Kazuyuki TAMURA (Naruto University of Education)
Head of the Secretariat	Yuki IHSIYAMA (Tottori University)
Director of JSFEE HQ	Kantaro TABIRAKI (Matsumoto University)
Accountant	Masahiro SAITO (Kochi University)
Conference Program	Tadashi OOTANI (Tottori University) Yuki IHSIYAMA (Tottori University) Kantaro TABIRAKI (Matsumoto University)
Events	Hitoshi NISHIMURA (Hiroshima Shudo University)
Public Relations and Messe	Osamu KOBAYASHI (Ehime University) Tadashi OOTANI (Tottori University)
International Exchange	Kazuyuki TAMURA (Naruto University of Education)
Public Symposium	Hisayoshi IKATSU (Kibi International University) Chikara IMAMURA (Yamaguchi Prefectural University)
Excursion	Miho HAYASHI (Mizushima Foundation) Yuki IHSIYAMA (Tottori University)

## 1 . Greetings from the Chairman of the Executive Committee

The 34<sup>th</sup> Annual Meeting (Tottori) Executive Committee Chair  
Tadashi OOTANI

Thank you very much for your participation in the 34th Annual Conference of the Japanese Society for Environmental Education (Tottori). Tottori University will be the main venue for this conference, which will be undertaken by the Chugoku and Shikoku Branch. If you look at the names of Conference Executive Committee members, you will see an unprecedented breadth of membership. Excursions include a walk through the Tottori Sand Dunes (San'in Kaigan National Park) and a cruise on the Mizushima Industrial Complex. Tottori University's basic philosophy is "fusion of knowledge and practice," and we have been focusing on education and research activities with the aim of contributing to solving environmental problems in the region, including the Arid Land Research Center. We hope that this annual meeting will serve as a catalyst to strengthen the University's commitment to environmental education and deepen its contribution to a sustainable future.

This conference will also be the first to be held since the new Coronavirus infection was moved to category 5. While this pandemic has at least temporarily slowed economic activity and reduced the impact of human activity on the environment, how can it be assessed from an environmental education perspective? The Great East Japan Earthquake and the nuclear power plant accident, as well as other natural disasters reported every year, should provide us with opportunities to fundamentally reconsider our relationship with nature, but have the lessons learned been put to use? At a time when we as human beings are being questioned about what attitude we should take toward the environment, we hope that you will join us at this conference to discuss your daily research activities toward the creation of a sustainable society.

This will be the second time the conference will be held in Tottori since the 18th annual meeting was held at Tottori University of Environmental Studies in 2007. At that time, the event was held in May, but this time it is August and the heat still seems to be intense. Please take good care of yourself and we look forward to seeing you in Tottori.

## 2. Outline of the Event

- **Period:** August 25 (Friday)—28 (Monday), 2023
- **Venue:** Tottori University Tottori Campus, Online (Zoom)  
Tottori Sand Dune Visitor Center (Aug 25, Excursion)  
Tottori Lifelong Learning Center Fureai Kaikan (Aug 25)  
Kurashiki City Environmental Learning Center (Excursion)
- **Host:** The Japanese Society for Environmental Education (The 34<sup>th</sup> Conference Organizing Committee)
- **Support:** Tottori Prefecture Board of Education; Tottori City Board of Education; EPO Chugoku; Chugoku ESD Center; Tottori Convention Bureau; Ministry of the Environment; Ministry of Land, Infrastructure, Transport and Tourism; Ministry of Agriculture, Forestry and Fishery; Ministry of Education, Culture, Sports, Science and Technology
- **Webpage for the 34<sup>th</sup> Annual Meeting of the Japanese Society for Environmental Education:**  
<https://www.jsfee.jp/members/meeting/113/576> (In Japanese)

## 3. Conference Schedule

	9 am	10 am	11 am	Noon	1 pm	2 pm	3 pm	4 pm	5 pm	6 pm	7 pm	8 pm	9 pm	
Aug 25 @ Tottori Sand Dunes Visitor Center & Tottori University								General Meeting of Members @ Tottori Sand Dune Visitor Center			Society Event(s) @ Tottori University			
Aug 26 @ Tottori University	Registration	Oral Presentations		Lunch Break	Society Event			Public Symposium	Roundtable Session	Reception				
		Oral Presentations (online)		Poster presentations (core time: Noon—1 pm)		Environmental Education Messe								
Aug 27 @ Tottori University	Registration	Oral Presentations			Research Projects		Independent Research Projects		Environmental Education Messe					
		Oral Presentations (Eng)		Int'l Exchange	Poster Presentations									

- The conference event (August 26), the public symposium, and the Environmental Education Messe are open to everyone (no need to pay conference registration fee).

### <Conference Details>

#### August 25 (Friday) @ Tottori Sand Dune Visitor Center, Tottori Lifelong Learning Center Fureai Kaikan

General Meeting	3:30 pm—4:30 pm (Tottori Sand Dune Visitor Center)
Society Event	6:00 pm—8:00 pm (Tottori Lifelong Learning Center Fureai Kaikan)

#### August 26 (Saturday) @ Tottori University Tottori Campus (Part of oral presentation is online)

Registration	8:00 am (University Educational Building (共通教育棟) 2F)
Oral Presentations (face-to-face, online)	9:00 am—Noon
Poster Presentations	9:00 am—3:00 pm (Core time: Noon—1:00 pm)
Society Event	1:30 pm—3:00 pm
Public Symposium	3:15 pm—5:45 pm /Free of charge to attend

Symposium Theme: **Weaving ourselves with gifts from nature and everyday lives**

Speakers: Mr. Itaru Watanabe & Ms. Mariko Watanabe (Talmary)

<https://www.talmary.com/about-us>

Miho HAYASHI (Mizushima Foundation)

<https://mizushima-f.or.jp/>

Coordinator: Tadashi OOTANI (Chairman, Conf. Org. Committee; Tottori University)

Roundtable Session (for members) 5:50 pm—6:50 pm

Reception 7:00 pm—9:00 pm

Environmental Education Messe 9:00 am—6:30 pm

August 27 (Sunday) @ English session & International Exchange is also available online)

Registration 8:00 am (University Educational Building (共通教育棟) 2F)

Oral Presentation 9:00 am—11:00 am

Research Award Judging 9:00 am—Noon

English Sessions 9:00 am—11:00 am

Poster Presentation 9:00 am—12:30 pm

International Exchange Program 11:00 am—12:30 pm

International Research Collaboration 12:30 pm—14:30 pm

Research Projects 12:30 pm—2:30 pm

Independent Research Projects 2:40 pm—4:10 pm

Environmental Educational Messe 9:00 am—2:40 pm

### Excursion

August 25 (Friday)

Tottori Sand Dune Tour @ Tottori City Tottori Sand Dune

August 28 (Monday)

Learning about environmental issues and change in industry (Mizushima Industrial Complex Cruise)

@ Kurashiki City Environment Study Center

## 4. About Venue

### <Access to Tottori University>

Address: 101 Minami 4-chome, Koyama-cho, Tottori-shi, 680-8550

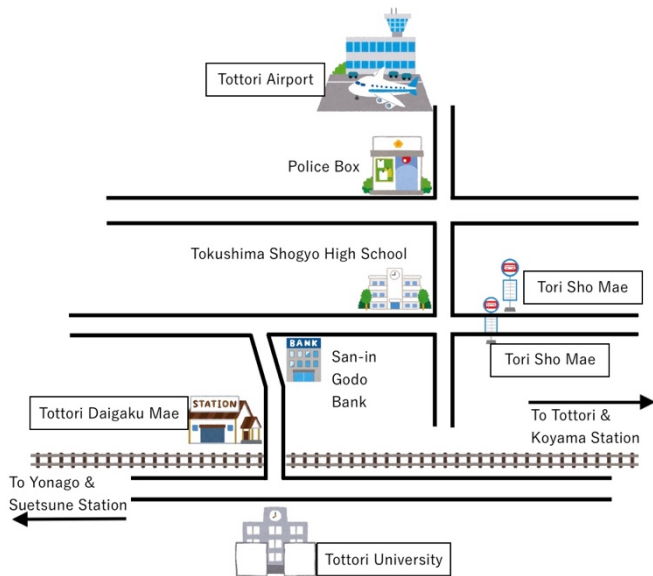

- **From Tottori Station**
  - **Via JR (Train, ¥190)**  
From “Tottori Station”, get off at “Tottori Daigaku-Mae Station” on the Sanin Honsen Line.  
3-minute walk
  - **Via Bus (Hinomaru Bus, ¥360)**  
Board at Tottori Station Bus Terminal  
**Bus #43 or 57:** Get off at “Tori-Dai” bus stop.  
Tottori Univ. is just in front  
**Bus #41, 44-47:** Get off at “Tori Sho Mae” bus stop.  
Tottori Univ. is a 5-min walk
  - **Via Taxi (about ¥2,000~3,000)**  
About 15 min from JR Tottori Station
- **From Tottori Airport**
  - **Via Taxi (about ¥1,000)**  
About 5 min
  - **Via Walking**  
About 20-min walk

### <Tottori University Campus Map>

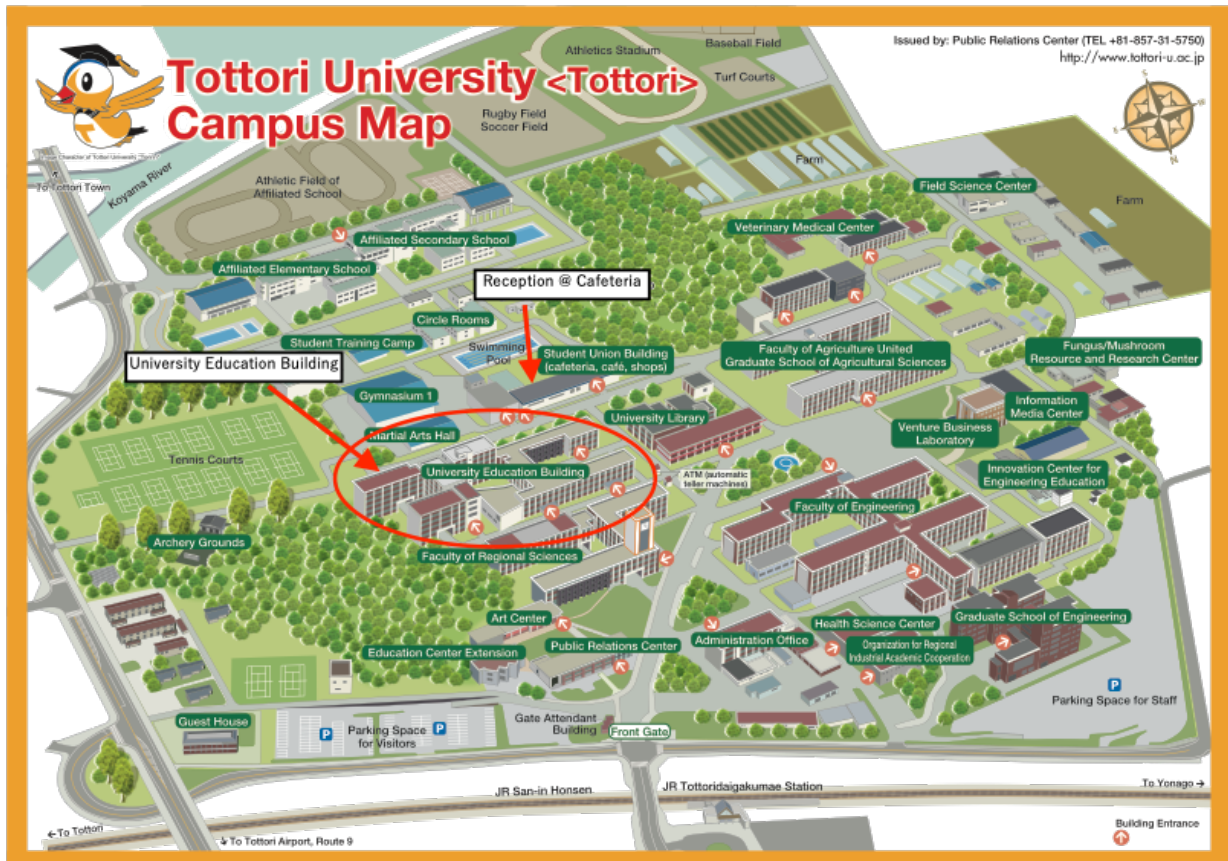



**<Access to Tottori Sand Dune Visitor Center>**

Address: 2164-971 Yuyama, Fukube-cho, Tottori-shi, Tottori, 689-0105

Nearest Bus Stop: “Sakyu-Kaikan” or “Sakyu-Higashi Guchi”

About 20-min bus ride from JR Tottori Station

Please use “Sakyu Line (Bus #39)” (to “Sakyu-kaikan” bus stop) or  
 “AION Line (Bus #32 & 33)” (to “Sakyu-Higashi Guchi” bus stop)

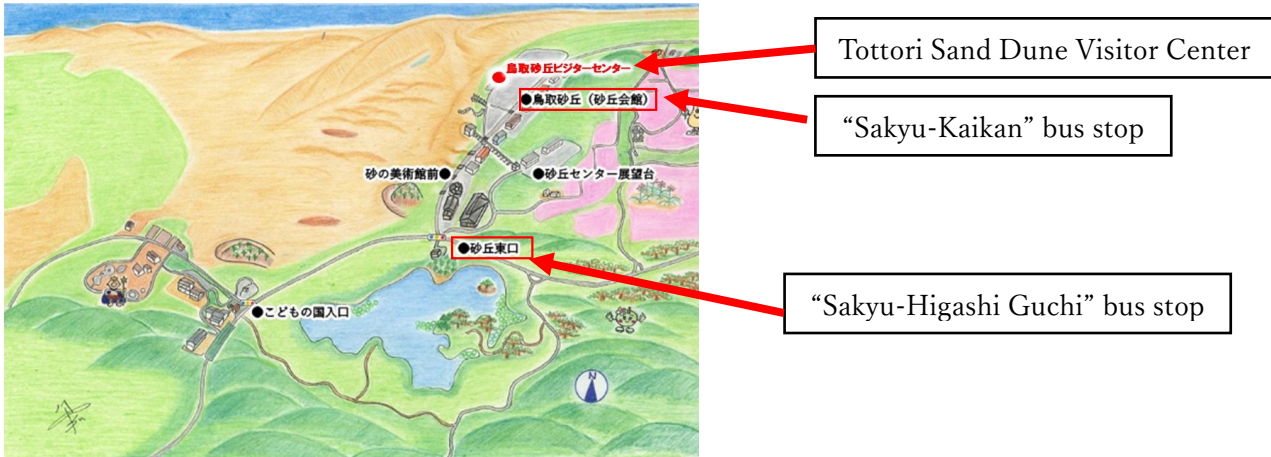

**<Access to Tottori Lifelong Learning Center Fureai Kaikan>**

Address: 21 Oogimachi, Tottori-city, Tottori Prefecture, 680-0846

3-min walk from JR Tottori Station South Exit

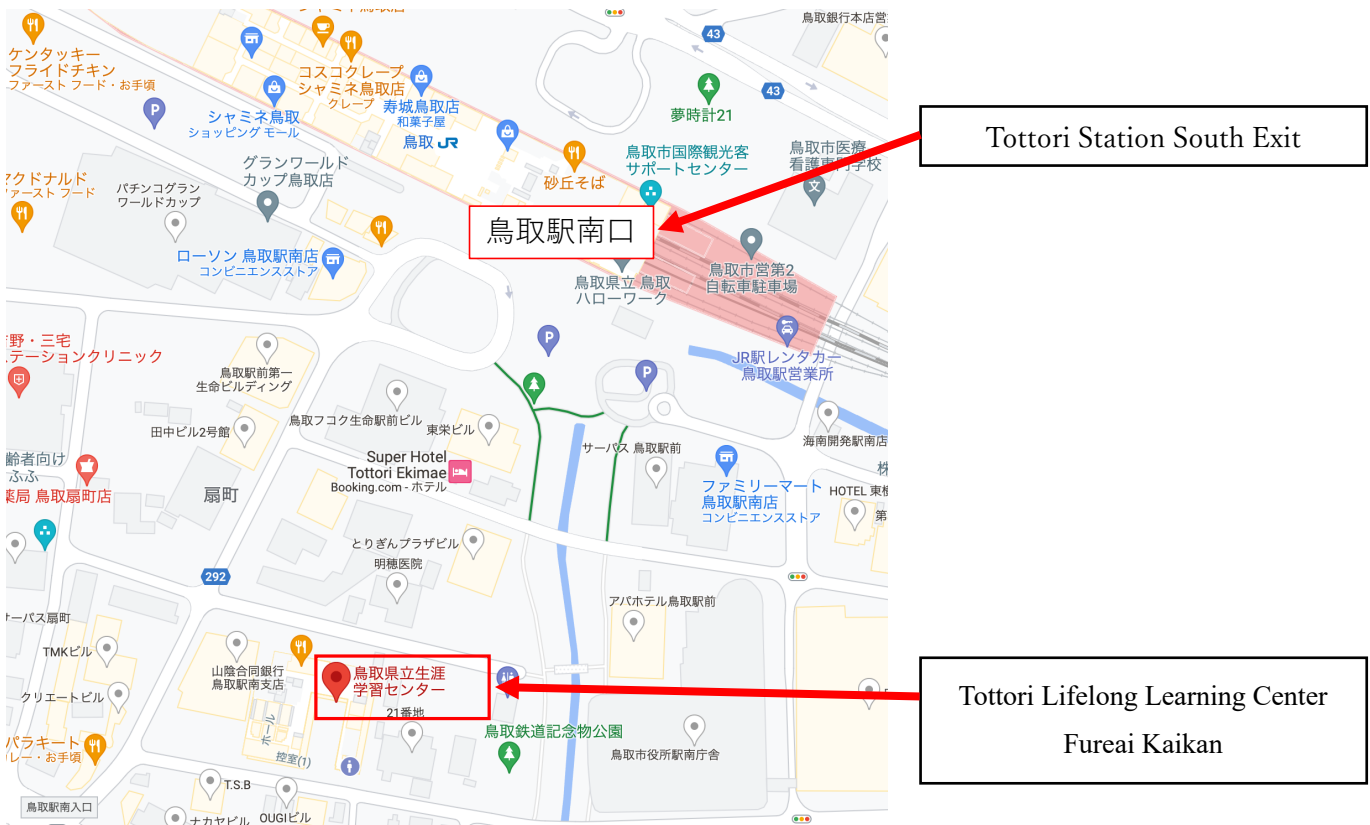

**<Place of Presentation (August 26—27)>**

Tottori University Tottori Campus, University Education Building

**Rooms:**

University Education Building (Please note that it is easy to get lost in the building.)

**Room C21:** Presentation Group A

**Room D21:** Presentation Group B, English Session, International Exchange Program, International Research Collaboration, Independent Research Presentation 1

**Room C31:** Presentation Group C, Research Project 1

**Room C32:** Presentation Group D, Research Award Judging, Research Project 2, Independent Research Presentation 2

**Room D31:** Presentation Group E, Research Project 3

**Room D42:** For attendants of Online sessions (only for August 26)

**Study Room 1:** Poster Presentation 1

**Study Room 2:** Poster Presentation 2

**Room D22:** Poster Presentation 3, Independent Research Presentation 3

**Room A20:** Society Event, Public Symposium, Roundtable Session.



● University Education Building (Please note that it is easy to get lost in the building.)

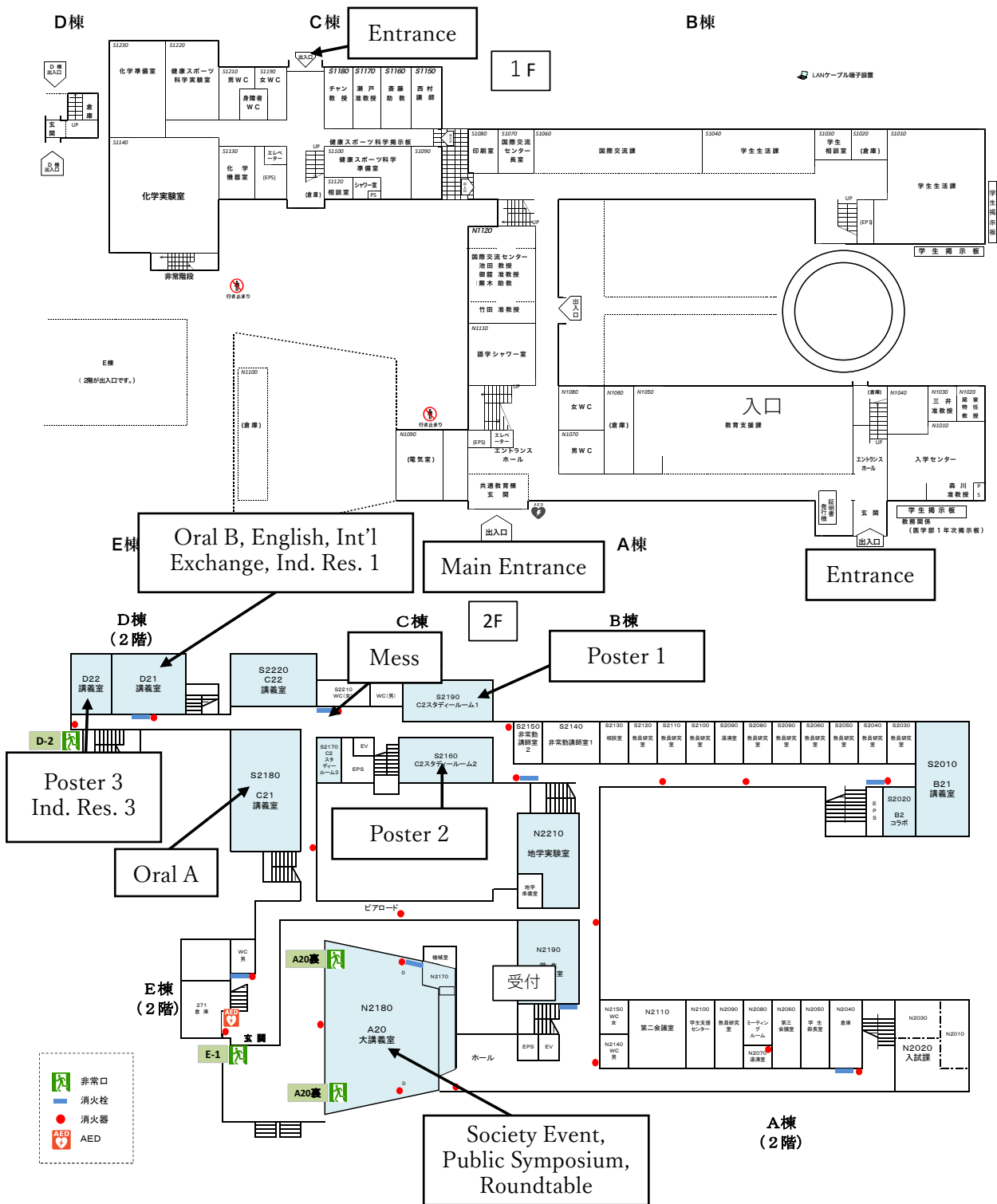

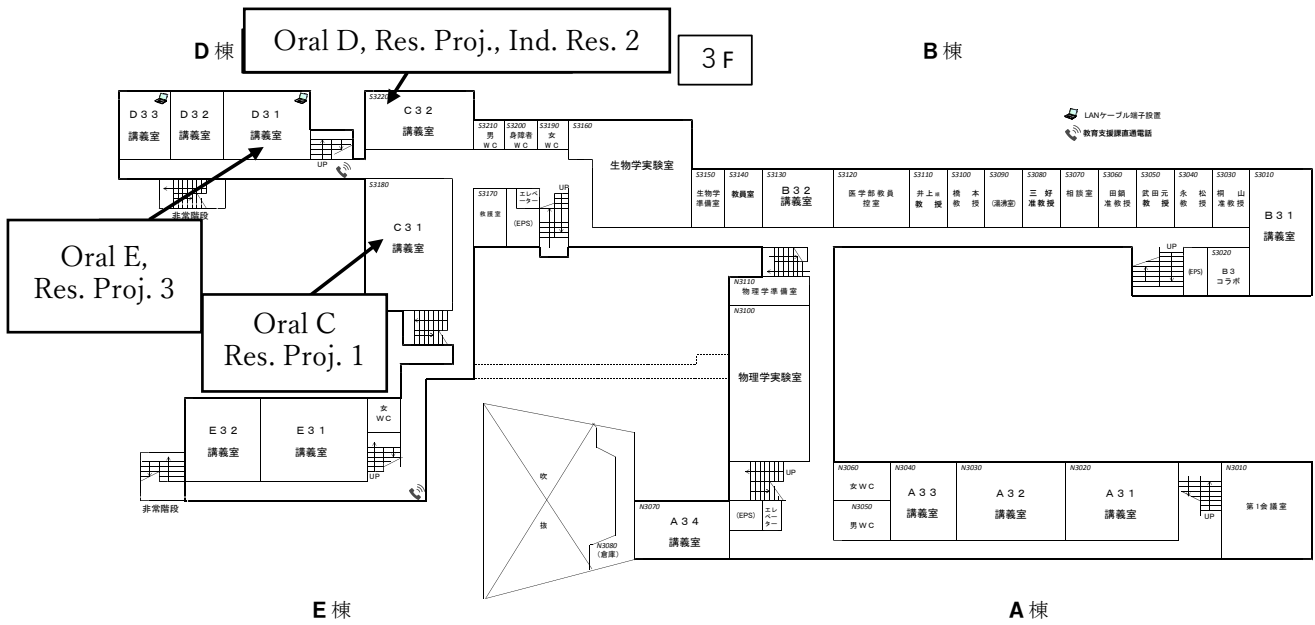

E棟

A棟

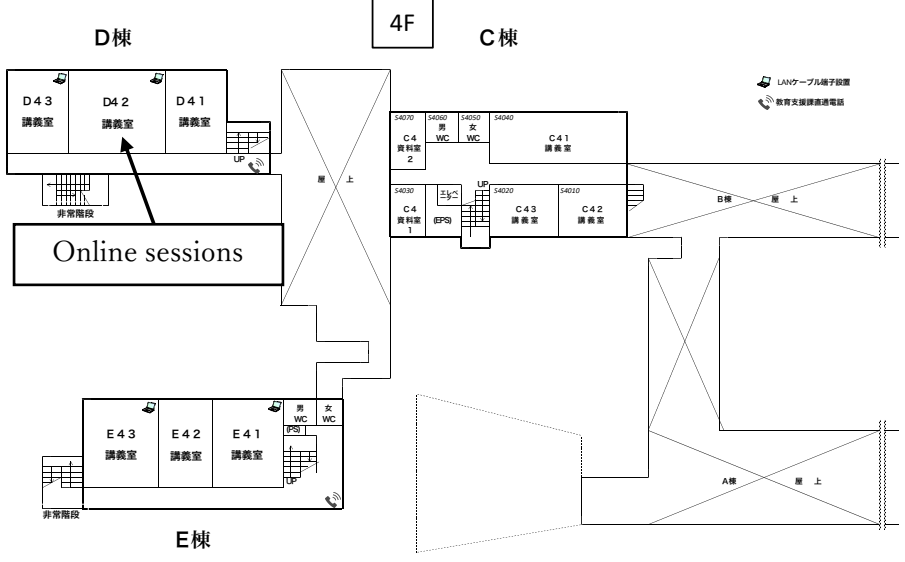

E棟

## 5. Information for Participants

### Online Participation

- ZOOM online conferencing system will be used for oral presentations (online). Please connect to the Internet from your computer, tablet, or smartphone to participate.
- Please check your computer operation, internet connection, video/audio, etc. in advance. (You can test your login at the link on the right: <https://zoom.us/test>)
- Please note that you will be responsible for any additional costs incurred for online participation, such as communication fees.
- Meeting rooms are assigned a meeting ID for each session. Please confirm and enter the Meeting ID and passcode that will be sent directly to the participant.
- When entering a meeting room, please set the name displayed on the ZOOM as "Name (Affiliation)".
- A room for listening to the oral presentations (online) will be reserved (Lecture Room D42). If you wish to listen to oral presentations (online) in the room, please bring your own PC, earphones, etc. to the room and connect them to the Internet. To avoid problems, please refrain from presenting your oral presentation (online) from that room.
- Those who wish to participate online must follow the presentation and auditing procedures specified by the Executive Committee. The Japanese Society for Environmental Education will not be held responsible for any problems that may occur when making a presentation at the online conference.
- Please do not record, tape-record, or screenshot video, audio, text logs, etc. during the presentation without the presenter's permission. Disclosure of such information to third parties through posting on social networking sites is prohibited.
- Please follow the instructions of the chairperson of each session regarding the use of the chat function and questions during the presentation.
- Due to the limited number of connections, do not use multiple devices for simultaneous connections.
- The chairperson and support staff may, at their discretion, forcibly turn off participants' microphones, cameras, screen sharing, etc., if they are found to be interfering with the smooth progress of the event. Please understand and accept this.

### Face-to-face Participation

- In General
- The conference registration desk will be located on the 2nd floor of the University Education Building on the Tottori University Tottori Campus from August 26 (Sat.) to 27 (Sun.). All participants must register here.
- You will receive your name tag at the registration desk. Please be sure to wear it at the venue.
- No one will be allowed to enter or leave any buildings or classrooms other than the venue during the conference.
- Smoking is not permitted in the venue. Please note that there is no smoking area.

- Wi-Fi access at the venue
  - Registered participants will be given a guest wireless LAN account ID and password for on-campus Wi-Fi access at the registration desk on the day of the event. You can also use eduroam; please refer to this website (<https://www.eduroam.jp/>) for more information about eduroam.
  
- Accommodation Information
  - Please make your own accommodation arrangements. The Executive Committee will not make reservations or arrange for accommodation. Please make your lodging arrangements as soon as possible.
  
- About meals
  - During lunch break, you can use the Tottori University cafeteria (in the University Hall).
  - There is no lounge available. If you need to take a break, please use the tables in the University Hall where the cafeteria is located, or the hall in front of Lecture Room A20 on the 2<sup>nd</sup> floor of University Education Building.
  - Please take your garbage home with you.
  
- Others
  - There is no cloakroom. Please carry your valuables with you.

## 6. About Oral Presentations

### Online Presentations

#### (Preparation)

- A ZOOM meeting ID will be assigned for each session. Please confirm and enter the Meeting ID and passcode that will be sent to participants.
- When entering the meeting room, please enter the name displayed on ZOOM in the order of "[Presenter] Name (Affiliation)". Example: [Presenter] Taro Tottori (Tottori University)
- Please make sure to connect in a telecommunication environment with sufficient connection speed.
- If you have a headset or earphones with a microphone, we recommend using them.
- You can test login at the following link. Please check the audio, etc. beforehand.
  - <https://zoom.us/test>

### (Presenters)

- Oral presentations will be given using Zoom.
- Presenters must enter the meeting room at least 5 minutes prior to the start of their session. During the session changeover, please check your camera and microphone, share the screen of your presentation materials, etc.
- The presentation time will be 15 minutes (12 minutes for presentation and 3 minutes for questions).
- The cues during the presentation are as follows.

First Ring:	10 min
Second Ring:	12 min (End of presentation time. Please stop your presentation.)
Third Ring:	15 min (End of Q&A session. Please turn off your microphone and camera.)

- Presenters should remain in the meeting room until the end of the general discussion of their session.

### (Audiences)

- When entering the meeting room, please enter your name as it appears on ZOOM in the order of "Name (Affiliation)".
- Please turn off your camera and microphone when listening to the presentations.
- Please follow the chairperson's instructions regarding the use of the chat function.
- Click on the reaction button (raise your hand) when you want to ask a question. After being nominated by the chairperson, turn on the camera and microphone and ask your question.
- Please cooperate for the smooth operation.

### (Session Chairperson)

- The chairperson is responsible for the entire session. Please take responsibility for the progress of the session from the presentation to the general discussion.
- No timekeeper will be set up. We ask that you also keep track of time.
- Before starting a session, please state whether the chat function is available or not.
- Please be punctual when proceeding.
- Please have the inquirer state his/her name and affiliation at the outset.
- Please be careful not to bias the discussion toward any particular presenter or speaker.

## Face-to-face Presentation

### (Preparation)

- Presenters are requested to bring their own PCs and tablets. No PCs will be available for lending at the venue. The projector will be connected to an HDMI terminal, so please prepare an environment where you can use the HDMI terminal.
- The presenter is responsible for the operation of his/her PC.
- Please bring your PowerPoint slides on a USB memory stick just in case. Please check your USB memory stick for viruses by yourself.
- Presenters are requested to check the HDMI connection during the session changeover time.

### (Presenters)

- Presenters are requested to wait at the front of the room for the next presentation.
- Presenters are required to state the title of the presentation and the name of the presenter at the beginning of the presentation.
- The presenters are requested to inform us of whether or not they are allowed to take photographs of the slides and other materials of their oral presentations prior to their presentations.
- The presentation time will be 15 minutes (12 minutes for presentation and 3 minutes for questions).
- The presentation for Research Award Judging will be 17 min (12 minutes for presentation and 5 minutes for questions).
- The cues during the presentation are as follows.

First Ring:	10 min
Second Ring:	12 min (End of presentation time. Please stop your presentation.)
Third Ring:	15 min (End of Q&A session. Please switch to the next presenter.)

- Presenters are requested to remain in the room until the end of the general discussion of their respective session.

### (Session Chairperson)

- The chairperson is responsible for the entire session. Please take responsibility for the progress of the session from the presentation to the general discussion.
- No timekeeper will be set up. We ask that you also keep track of time.
- Before starting a session, please state whether the chat function is available or not.
- Please be punctual when proceeding.
- Please have the inquirer state his/her name and affiliation at the outset.
- Please be careful not to bias the discussion toward any particular presenter or speaker.

## 7 . About Poster Presentations

### (Preparation)

- Presenters are requested to post their posters in the designated location by 9:00 a.m. on Saturday, 26th.
- Poster space is limited to one A0-size sheet per poster.
  - (H:1189mm x W:841mm, imitation paper size <1090mm x 790mm> is also acceptable)
- The conference executive committee will provide studs and tape for mounting posters. Please do not use tape you have prepared yourself.
- If you do not wish to have your poster photographed, please post a notice to that effect by yourself.

### (Presenters)

- Presenters are requested to stand in front of their posters during the core time (12:00~13:00) on Saturday, 26th for the Q&A session.
- - Presenters do not need to be present at all times except for the core time.

### (Clean-up)

- Please remove your posters at 12:30 p.m. on Sunday, March 27, to complete the clean-up.
- Any posters left on display after the removal time will be disposed of by the executive committee. Please note that we will not keep them.

## 8 . About Independent Research Presentations

- The organizer is responsible for setting up and running the venue for the face-to-face meeting, and must return the venue to its original state after the event is over.
- The representative and members of the team are responsible for facilitating the event.
- Please keep strictly to the closing time.

### **Room D21:** Independent Research 1

- Learning Qualitative Research Methods 10: Qualitative Research Methods in Practice-Based Research Using Picture Books

### **Room D22:** Independent Research 3

- Experience the board game "Zoonosis - SFTS Virus Strategy"

### **Room C32:** Independent Research 2

- Environmental Education, ESD, SDGs and Disaster Prevention, Mitigation and Recovery



## 9. Society Events for Participants

### ● Society Event

**Date & Time:** August 25 (Friday), 6:00 pm—8:00 pm

**Venue:** Tottori Lifelong Learning Center Fureai Kaikan

**Theme:** “Exchange & stepping up of academic members who are starting out as researchers and practitioners!”

Building on past events such as seminars on how to write papers and gatherings for young members, we intend to provide a forum for those who have started working on their research or practice and those who want to write papers in the future to interact and step up their efforts. The session will include an explanation of the status of submission to the Journal and key points of peer review, which will be helpful for those who are interested in submitting papers to the Journal for the first time and for those who are interested in submitting papers to the Journal, as well as a discussion of the activities of each Regional Branch and the promotion of information sharing among Branches, and an exchange of opinions. Please join us as a chance to expand your research and practice activities in the future.

#### **Recommended for:**

- Those attending the Annual Conference for the first time.
- Young people who have generally been involved in research and practice for less than 10 years.
- Those who are beginning to work in a new academic discipline or field, or are seeking an exchange for this purpose.
  - There are no age or other restrictions, so anyone who is interested is welcome to participate.

#### <Schedule>

6:00 pm—6:20 pm: Explanation of the purpose of the meeting and the current status of young members as a percentage of the Society's membership.

6:20 pm—6:40 pm: Guide to submitting your first paper.

6:40 pm—7:00 pm: Introduction of activities from each branch.

7:00 pm—8:00 pm: Exchange meeting

### ● English Report Presentations

**Date & Time:** August 27 (Sunday), 9:00 am—11:00 pm

**Venue:** University Education Building, Room D21

The conference will have an "English Reporting Session" during the oral presentations (9:00am—11:00 am) on August 27 (Sunday), which will be conducted entirely in English. The presentation format is the same as for oral presentations: oral presentation (face-to-face or online), Q&A, and general discussion.

We encourage not only participants who will be presenting in English, but also all other members to actively participate in the English Reporting Subcommittee. For details, please see below in the research presentation program.

For online participants, please check the Zoom ID and passcode sent to participants.

### ● International Exchange Meeting

**Date & Time:** August 27 (Sunday), 11:00 am—12:30 pm

**Venue:** University Education Building, Room D21

**Theme:** “The Past and Future of JSFEE's International Exchange”

**Essentials:** What is the Society's International Exchange Committee's involvement, achievements, and challenges?  
Based on case studies

**Target:** Members interested in international exchange and international collaboration (both researchers and practitioners)

**Topics:** International joint research through the introduction of past activities, exchange projects, and interaction with International Exchange Committee Members

**Languages:** Japanese and English

### ● International Research Collaboration

**Date & Time:** August 27 (Sunday), 12:30 pm—14:30 pm

**Venue:** University Education Building, Room D21

**Theme:** “Overview of the JSFEE International Collaborative Research Projects (ICREP)”

This session introduces the overview of the JSFEE International Collaborative Research Projects (ICREP) and the English-language online issue of the Japanese Journal of Environmental Education to explore the theme “environmental education in Asia.”

### ● Research Projects

**Date & Time:** August 27 (Sunday), 12:30 pm—14:30 pm

**Venue:** University Education Building, Room C31

“Pollution Education” Research Project lead by Ken Takada (Tsuru University)

**Venue:** University Education Building, Room C32

“Education on the SDGs” Research Project lead by Yukihiro Asaoka (Tokyo University of Agriculture and Technology)

**Venue:** University Education Building, Room D31

“Evaluating Environmental Education Programs” Research Project lead by Takahiro Nakaguchi (Shibaura Institute of Technology)

### ● Roundtable Session for Members

**Date & Time:** August 26 (Saturday), 17:50 pm—18:50 pm

**Venue:** University Education Building, Room A20

### ● Reception

**Date & Time:** August 26 (Saturday), 7:00 pm—21:00pm

**Venue:** University Cafeteria

## 10. Public Events

### ● Society Event

**Date & Time:** August 26 (Saturday), 1:30 pm—3:00 pm

**Venue:** University Education Building, Room A20

**Theme:** “Considering children's climate change studies: from the field of climate change studies in the community.”

**Registration:** On site (Both members and non-members are welcome to join)

Two global warming prevention activity centers in the San-in region provide examples of regional climate change learning as topics for discussion, and together with participants engage in a world café-style dialogue on the regional development of climate change learning.

Although the issue of climate change is often explained in terms of its mechanisms and calls for actions that individuals can take, from the perspective of environmental education, we see the importance of nurturing people who can lead to social change through a variety of experts and sectors. This may be seen in the environmental learning practices being undertaken in the community. We would like to explore the possibilities of what approaches and experiences are desirable.

#### <Schedule>

- Greetings and guidance
- Topic 1: Climate Change Learning Practices at Tottori Prefectural Center
- Topic 2: Climate Change Learning Practices at Shimane Prefectural Center
- World Café "Characteristics and Key Points of Climate Change Learning in the Community" (20 minutes x 2 rotations)
- General review and summary talk

#### < Collaborators and Topic Providers >

- Tottori Global Warming Prevention Activity Center/Climate Change Adaptation Center  
Zero-Carbon Tottori
  - <https://www.t-ccca.org/>
- Shimane Center for Climate Change Actions, Eco Support Shimane  
Shimane Nature and Environment Foundation (Public Foundation)
  - <https://www.nature-sanbe.jp/eco/>

### ● Public Symposium

**Date & Time:** August 26 (Saturday), 3:15 pm—5:45 pm

**Venue:** University Education Building, Room A20

**Theme:** “Weaving ourselves with gifts from nature and everyday lives”

**Speaker 1:** Mr. Itaru Watanabe & Ms. Mariko Watanabe (Talmary)

**Speaker 2:** Miho HAYASHI (Mizushima Foundation)

We are reluctant to recognize problems not only because they are complex, but also because

we deliberately avoid looking at them. Environmental education was supposed to begin by bringing awareness to that which has been made invisible. We would like to explore the opportunity for such learning to bring to light a debt that we have unknowingly imposed on someone far away, on someone in the future, and on ourselves, and that it is rather a positive experience.

Since 2015, Mr. Itaru Watanabe and Ms. Mariko Watanabe have been operating Talmay, a bakery in the town of Chigashira, Tottori Prefecture, that ferments its products using only wild koji-mold (yeast). The part of the conference theme, "gifts from nature," was taken from a word that describes koji-mold coming down under the influence of the local environment, houses, and the people who work there. They will share what they have realized from their involvement with wild molds and how baking is inevitably linked to community and environmental initiatives.

The other part of the conference theme, "weaving ourselves with everyday lives," is also a key phrase for Miho Hayashi of the Mizushima Foundation. The program coordinates the dialogue between victims and perpetrators of pollution and the process of finding new value in the seemingly negative event of pollution. Knowing how the revitalization of polluted areas, which does not always proceed in a harmonious manner, is being carried out will provide hints for solving all kinds of environmental problems.

## ● Environmental Education Messe

**Date & Time:** August 26 (Saturday), 9:00 am—6:30pm & August 27 (Saturday), 9:00 am—2:40 pm

**Venue:** University Education Building, 2<sup>nd</sup> Floor

Please use this as a place to introduce your organization and its activities and to communicate with conference participants and members.

Exhibiting organizations (in alphabetical order): Asakura Publishing Co. Ltd., Kofu Town Hall, Kurumiya, Rural Culture Association Japan (Noubunkyo)

- No use of fire or serving of food and beverages is allowed at the Environmental Education Messe venue.
- Please keep sales under the control of each organization to avoid any problems.

## 11. 研究発表プログラム

### ●口頭発表（オンライン）

※登壇者（筆頭者）として登録された 1 名のみ氏名を掲載しています。

26 日（土）：9:00～9:55

会場	9:00～	9:15～	9:30～	9:45～
オンライン ①	[26G01] 若林 身歌 ドイツにおける環境教育 学の視座に関する研究	[26G02] 酒井 佑輔 日本の環境教育における パウロ・フレイレー宇井 純の語りと自主講座「公 害原論」から—	[26G03] 長濱 和代 森と人とのつながりを取り 戻す —森林資源の持続的利用 の条件—	総合 討論

26 日（土）：10:00～10:55

会場	10:00～	10:15～	10:30～	10:45～
オンライン ①	[26G04] 岡山 咲子 環境活動における学外の 社会人とのやりとりが学 生に与える意識変化と実 務能力向上について	[26G05] 斉藤 千映美 自然との関わりを学ぶ植 物栽培—教員養成課程に おける授業改善の取り組 み—	[26G06] 渡部 聡子 ドイツの学校外教育にお ける「包摂」の組織的推進	総合 討論

26 日（土）：11:00～11:55

会場	11:00～	11:15～	11:30～	11:45～
オンライン ①	[26G07] 佐藤 秀樹 開発途上地域における環 境 NGO 職員の能力開発 に関する考察～バングラ デシュの事例から	[26G08] 遠藤 晃 ユネスコ BR における ESD の実践研究 -ニホン カモシカに関するステー クホルダーの協働-	[26G09] 松井 晋作 公害教育と自然保護教育 から見る日本の環境意識	総合 討論

会場	11:00～	11:15～	11:30～	11:45～	12:00～
オンライン ②	[26H01] 高橋 彬 高等学校の復興教 育における図書館 活用の可能性—岩 手県立釜石高等学 校の STEEL 教育に 着目して—	[26H02] 乗原 智美 「都内高校生にお ける野外炊事と環 境意識から学習の 可能性を探る」 —共生社会につな がる視点を意識し て—	[26H03] 飯沼 慶一 低学年未分化論か ら見た小学校低学 年環境教育	[26H04] 三木 柚香 戦争と公害 その つながりと語りを めぐる—考察	総合 討論

●口頭発表（対面）

※登壇者（筆頭者）として登録された 1 名のみ氏名を掲載しています。

26 日（土）：9:00～9:55

会場	テーマ	9:00～	9:15～	9:30～	9:45～
A 会場 C21 講義室	原発 事故	[26A01] 後藤 忍 福島県環境創造センター交流棟のリニューアル前後における展示説明文の内容分析	[26A02] 鈴木 隆弘 原発事故に関する取組みの検討 – 教育系学会を中心にした資料の収集と予備考察 –	[26A03] 鈴木 一正 福島原発事故における保養プログラム：コロナ禍の実態	総合 討論
B 会場 D21 講義室	教育 プログラム 1	[26B01] 桜井 良 ウェアラブルカメラ装着実験から考える環境教育プログラム評価の新たな可能性	[26B02] 冨田 俊幸 ESD 並びに SDGs の評価ツールの開発	[26B03] 長原 未緒 フィールドワークにおける教育効果推定のための頭部方向検出に適したセンサ選定	総合 討論
C 会場 C31 講義室	学校 教育 1	[26C01] 王子杰 大人と子供の協働による家庭系食品ロス削減プログラムの開発 ～ 農業体験と日常的な食材・食事管理の組み合わせによる～	[26C02] 中村 和彦 小学校第 5 学年での森林学習の経験が中学校進学後の森林認識に及ぼす影響	[26C03] 許 容瑜 台湾における緑化木調査に関する学習活動の評価	総合 討論
D 会場 C32 講義室	幼児	[26D01] 藤井 徳子 幼児期の自然体験がもたらす教育効果について	[26D02] 田中 住幸 国内外の幼児期の環境教育・ESD の展開	[26D03] 加藤美由紀 外来生物についての幼児期の環境教育活動の実践	総合 討論
E 会場 D31 講義室	国際 交流	[26E01] 新堀 春輔 マレーシアにおける脱炭素社会実現に向けた環境教育・環境保全活動の実践	[26E02] 田村 憲司 二国間交流を通じた国際環境教育の推進	[26E03] 板倉 浩幸 国際交流を通じた日本の環境教育研究・実践者の学び – マレーシア Univertiti Tunku Abdul Rahman (UTAR: トウク・アブドゥール・ラーマン大学) とのオンラインワークショップを事例に –	総合 討論

26日(土): 10:00~10:55

会場	テーマ	10:00~	10:15~	10:30~	10:45~
A会場 C21 講義室	教材1	[26A04] 渡部 裕司 世界の環境問題と私たちのくらしのつながりを理解する教材の開発～ブラジルの熱帯林破壊を事例に	[26A05] 尾上 茉莉 畜産動物についての意思決定・合意形成を促すための理科教材開発に向けた予備的検討～採卵鶏のアニマルウェルフェアを中心に～	[26A06] 福井 智紀 ロールプレイ型市民陪審によりブラックバス駆除に関する意思決定・合意形成を支援する中学理科教材の開発	総合 討論
B会場 D21 講義室	教育 プログラム2	[26B04] 新井 雅晶 自然体験活動と創作活動を接続した環境学習の工夫	[26B05] 中山 孝志 企業対象の生物多様性・SDGs教育手法の開発と実施	[26B06] 甲田 紫乃 持続可能な社会に向けた地域文化の醸成に資する環境教育プログラムの開発と実践	総合 討論
C会場 C31 講義室	学校 教育2	[26C04] 張 馨キ 地域の持続可能性に資する中学校でのプログラム開発と評価 —京都市京北地域における授業実践事例—	[26C05] 竹本 裕之 中高生における他の生物へのポジショニングを通じた環境学習の試み：なりきり作文を用いた検討	[26C06] 森 朋子 中学校におけるシビック・アクション促進プログラムの実践と評価	総合 討論
D会場 C32 講義室	自然 体験	[26D04] 佐藤 健治 不登校支援教育における自然体験学習の課題—「川崎市子ども夢パーク」の成立と発展—	[26D05] 孫 悦 コロナ禍における自治体連携型自然学校の対応特徴と課題 —グリーンウッド自然体験活動センターを事例に	[26D06] 佐々木 啓 ビジターセンターの展示鑑賞による防災・観光・環境に関する意識の変化	総合 討論
E会場 D31 講義室	地域1	[26E04] 黄 璇 中国における市民科学の実践が流域住民の環境意識と行動に与える影響の検討：貴州省貴陽市の「双河長制」の実施を通して	[26E05] 萩原 豪 温泉地から考えるESD展開の可能性	[26E06] 陳 佳虹 ESDとしての農山村女性の学習運動—千野陽一の研究を手がかりに—	総合 討論



26日(土): 11:00~11:55

会場	テーマ	11:00~	11:15~	11:30~	11:45~
A会場 C21 講義室	教材2	[26A07] 樋口 昇 気体センサー活用による科学的な概念形成とSDGs目標達成の関係に関する研究	[26A08] 小野瀬剛志 保育者養成校における小学生を対象とした気候変動教育の教材開発の試み	[26A09] 原 敬一 ミツバチ教材のポテンシャル	総合 討論
B会場 D21 講義室	教育 プログラム3	[26B07] 深澤 陸 森林散策において地下足袋の着用がもたらす体験と認識の実践的検討—足裏感覚を強化した森林体験プログラムの開発に向けて—	[26B08] 笹野 仁美 市民性を育む体験的な学びのあり方に関する研究—学び手の変容を促す要因の分析を通して—	[26B09] 増田 直広 自然保育者養成における自然体験活動指導者養成講習会の意義と課題	総合 討論
C会場 C31 講義室	博物館	[26C07] 山本 理 SDGs時代における「地域づくり教育」拠点としての博物館の可能性について—博学連携を通じた学力形成への一考—	[26C08] 畑田 彩 環境教育と鑑賞教育の融合—国連子どもの環境ポスターを活用した環境教育	[26C09] 林 浩二 博物館と持続可能性—国際博物館会議(ICOM)の取り組み	総合 討論
D会場 C32 講義室	動物	[26D07] 大森 和樹 デューイの思想から考える動物園・水族館の教育的意義	[26D08] 高橋 正弘 対馬市における希少野生生物保護を目的とした環境教育の効果および課題の分析	[26D09] 本田 裕子 コウノトリ学習の教育効果を検討する—兵庫県豊岡市「ふるさと教育」の事例から	総合 討論
E会場 D31 講義室	地域2	[26E07] 浜 泰一 南大東島におけるスメルスケープ・マップの作成	[26E08] 大島 順子 世界自然遺産地域における気候変動教育:地域住民への普及・啓発の取組み	[26E09] 今宮 則子 子どもたちによる社会への働きかけを目指した環境教育実践—西表島とニューヨークの小学校の交流を軸にして—	総合 討論

27日(日): 9:00~9:55

会場	テーマ	9:00~	9:15~	9:30~	9:45~
A会場 C21 講義室	教材3	[27A01] 田開 寛太郎 環境教育の目的に適合したVR教材の開発と実践に向けて	[27A02] 原 理史 デジタルアースを活用した地域環境 ESD の実践	[27A03] 森元 真理 生き物と暮らしをつなぐ 絵本教材のデザイン	総合 討論
B会場 D21 講義室	英語報告部会				
C会場 C31 講義室	自然観 1	[27C01] 李婉 森林環境教育に対する日本と中国の住民意識に関する考察	[27C02] 内藤 光里 京都市における脱炭素ライフスタイル行動の実態と行動変容の阻害要因	[27C03] 藤岡 達也 SDGs の観点からみた鳥取県の自然災害と自然景観	総合 討論
D会場 C32 講義室	奨励賞審査				
E会場 D31 講義室	思想・ 理論1	[27E01] 新田 和宏 共通だが共有されていない環境教育の課題:比較教育学と教育社会学の融合的アプローチ	[27E02] 西村 仁志 インタープリテーションの現代的意義	[27E03] 齊藤 雅洋 ESD としての防災教育の原理的考察(その2)	総合 討論

27日(日): 10:00~10:55

会場	テーマ	10:00~	10:15~	10:30~	10:45~
A会場 C21 講義室	教育 実践	[27A07] 多田 満 社会対話「環境カフェ」の実践ー「気候変動」をテーマにー	[27A08] 松田 剛史 「環境配慮を意図した生活スタイルを提案する学生プロジェクトの実践」	[27A09] 福田 美紀 SDGs 実施プロセスにおけるユースの参画：フィンランドと日本の比較研究	総合 討論
B会場 D21 講義室	英語報告部会				
C会場 C31 講義室	自然観 2	[27C04] William R. Stevenson III ノウイングネイチャー ガーデン・ベースド・ラーニングと日本の大学生における自然意識	[27C05] 大塚 啓太 自然に対する愛着感 は大学進学先選択に影響するか？--都市/地方進学直後の大学1年生への心理調査より--	[27C06] 芳賀 普隆 環境保全に関する大学生の学びにおける学生の意識に関する考察ー「地域プロジェクト活動」の事例ー	総合 討論
D会場 C32 講義室	奨励賞審査				
E会場 D31 講義室	思想・ 理論2	[27E04] 東 照晃 公害教育（環境教育）と同和教育（人権教育）の共通性とその課題	[27E05] 溝田 浩二 モンsoonアジアの風土を生かした環境教育ー100年前の日本人の暮らしを求めてラオスを歩く	[27E06] 秦 範子 脱成長を実現する<再ローカリゼーション>とは：アグロエコロジーを事例に	総合 討論

●口頭発表（英語報告部会）

※登壇者（筆頭者）として登録された 1 名のみ氏名を掲載しています。

27 日（日）：9:00～11:00

会場	9:00～	9:15～	9:30～	9:45～
B 会場 D21 講義室	[27B01] ZHANG Gegenduoren Comparative Study on School and Community Education from the Perspective of Sustainable Development Education --Case study in Inner Mongolia, China and Japan	[27B02] Hancheng You Study of Factors Promoting Pro- Environmental Behavior in a Private University Student in Japan	[27B03] Hyun Kim Addressing Carbon Neutrality In Environmental Education of Korea	総合 討論

会場	10:00～	10:15～	10:30～	10:45～
B 会場 D21 講義室	[27B04] Tseng, Yu-Chi An exploratory study of the influential socially significant life experiences on school teachers' teaching behaviors in environmental education	[27B05] Sachi Ninomiya-Lim Exploring the “Japanese Model” of Environmental Education – Based on the Virtual Workshops for Malaysian Early Childhood Educators	[27B06] Jeonghoon KIM Reviewing the Model Schools for Carbon Neutrality in Korea with Whole School Approach perspective	総合 討論

●口頭発表（奨励賞審査）

会場	9:00～	9:05～	9:22～	9:39～	9:56～
D会場 C32 講義室	会長 挨拶	[27D01] 河村 幸子 動物福祉を考慮した学校飼育動物を支える地域ボランティアの可能性～ヤギがつなげるまちづくり～	[27D02] 安嶋 汰粋 メディア論から考える動物園・水族館のライブ性	[27D03] 尾辻 朋音 展示閲覧前の情報提供が水族館来訪者の行動や展示理解に及ぼす影響—信濃川の生物展示における検証—	[27D04] 高橋 宏之 国際的にはじめての動物園における保全教育戦略構築に関する実践

10:30～	10:47～	11:04～	11:21～	11:38～
[27D05] 矢野 沙帆 ゲーミフィケーションを適用したSDGs 行動を促す幼児期 ESD 教育プログラムの開発および効果の検証	[27D06] 宇都宮 俊星 探究活動の導入に焦点を当てた討論型理科教材の開発と実践—海洋酸性化を題材とした意思決定・合意形成の支援—	[27D07] 浅岡 永理 単独自治体型ユネスコエコパークにおける ESD の促進要因	[27D08] 山田 輝 官民の資料館による公害教育の展開—新潟県阿賀野川地域を事例として—	[27D09] 川尻 剛士 「不可視性」に對峙する公害経験継承はいかにして可能か

## ●ポスター発表

26日(土) 9:00~15:00 (コアタイム 12:00~13:00) 27日(日) 9:00~12:30

※登壇者(筆頭者)として登録された1名のみ氏名を掲載しています。

<ポスター会場①:スタディールーム1>

- P1 Li-Hsuan Liao: The Influence of Climate Change Risk Perception, Self-efficacy and Psychological Adaptation on Intention of climate action among adults in Taiwan.
- P2 Mi-Wha Jang: Research on Interdisciplinary Educational Program Development: Based on Ecological Sensitivity and Caring Thinking
- P3 二井 菜月: 大学生の身近な動物に対する関心・意欲と関わり方の許容範囲
- P4 長島 優斗: 大学生の放置竹林問題に関する知識・経験・関心の状況
- P5 石岡 夢葵: 身近なムシに対する好きと嫌いの印象と関わり方の許容範囲
- P6 大西 春帆: 木育教室「丈夫で、津波に強い木は、重い木と軽い木のどっち?」の開発・実施・評価
- P7 藏田 大和: 木育教室「重い木と軽い木で鍵盤を作った木琴は、どのように音が違うのか?」の開発・実施・評価
- P8 洪 筱筑: 環境アイデンティティ、自己効力感と持続可能な消費に関する関連性—台湾大学生のサステナブルファッションな衣料品の購入と保存について

<ポスター会場②:スタディールーム2>

- P9 田村 和之: 徳島県における海浜漂着ごみ
- P10 田中 美帆: 海洋ゴミを用いたワークショップ形式の海洋教育—KJ法による分析結果—
- P11 堀江 慧悟: 三重県鳥羽市の全小中学校を対象とした海洋教育プログラムの実施とアンケート調査
- P12 高橋 一秋: 海岸防災林ジオラマ教材の開発・実施・評価—樹木の根の形状と津波に対する耐性の関係を学ぶ—
- P13 佐藤 幹太: 身近な絶滅危惧の淡水魚に対する地域住民の価値観とそれに影響を及ぼす要因 岡山市アユモドキを事例として
- P14 永野 昌博: 市民協働による生物多様性データベースの開発
- P15 池田 珠美: 「見える化した共有方法による更なる環境配慮行動促進の可能性」
- P16 井村 礼恵: 保育学生が考える乳幼児対象SDGs教育について  
~東京ディズニーランドにおける「多様性」の事例から~
- P17 梶浦 恭子: 保育者、教員養成におけるかがく絵本を教材にした自然とのかかわり

<ポスター会場③: D22 講義室>

- P18 安富 勇希: 外国籍市民の社会参画を促す要因とは—浜松市のブラジル籍市民を対象としたインタビュー調査—
- P19 丸本 倍美: 公害発生地域の小学生に対する水銀に関するアウトリーチ活動
- P20 山下 由貴: 環境教育のための草木染の活用—外来植物を用いた経木染色の可能性—

- P21 西村 和代：学校教育を再生するための「エディブル・エデュケーション」と環境教育の関連  
公立小学校における食育菜園の事例を通して"
- P22 島 麻希子：自然の中での「体験型」の学び前後における意識変容の調査概要報告
- P23 安藤 匡哉：武田薬品「京都薬用植物園」の重点取組と今後の展望
- P24 岡部 龍登：漫画手法を取り入れた展示による生物多様性保全意識向上の試み
- P25 小泉 伸夫：マダニ由来感染症を疑似体験するボードゲームの開発
- P26 倉田 薫子：少年院における生物多様性教育の実践

### Contact Information (for inquiries)

Conference Organizing Committee for the 34<sup>th</sup> Annual Meeting of the Japanese Society for Environmental Education

Ishiyama Research Lab, Faculty of Regional Sciences, Tottri University

4-101 Koyama-cho Minami, Tottori, 680-8551, JAPAN

E-mail: [tottori2023.jsfee\[at\]gmail.com](mailto:tottori2023.jsfee[at]gmail.com) (please change [at] to @)

Webpage for the 34<sup>th</sup> Annual Meeting of the Japanese Society for Environmental Education (Tottori): [https://www.jsfee.jp/members/meeting/113-annual-meeting/576-jsfee34\\_tottori2023](https://www.jsfee.jp/members/meeting/113-annual-meeting/576-jsfee34_tottori2023) (Japanese)

[https://www.jsfee.jp/en/meeting\\_en/577-jsfee34\\_tottori2023](https://www.jsfee.jp/en/meeting_en/577-jsfee34_tottori2023) (English)

Secretariat for the Japanese Society for Environmental Education

infotec Co. Ltd.

2-6-1 Ochiai, Tama City, Tokyo, 206-0033

Tel: +81-42-311-3355

Fax: +81-42-311-3356

e-mail: [office\[at\]jsfee.jp](mailto:office[at]jsfee.jp) (please change [at] to @)

Webpage for the Japanese Society for Environmental Education: <https://www.jsfee.jp/>